



Solent University's New Sports Complex

Located on the northern end of the East Park Terrace Campus, the new Solent University sports complex supports the university's ambition to increase its profile and standing in the British Universities and Colleges Sports League. The complex enables excellence for degree-level courses spanning from sport-related programmes to health and fitness studies.

ARCHITECT

Architecture PLB

DEVELOPER

Morgan Sindall

PSP CLIENT

Coverworld Construction

PSP SYSTEM

Bespoke External Panels

www.pspuk.com

Solent University's New Sports Complex

PSP Group work in synergy with the supply chain at the early design stages to achieve a truly outstanding facade solution that meets all aesthetic and technical requirements.

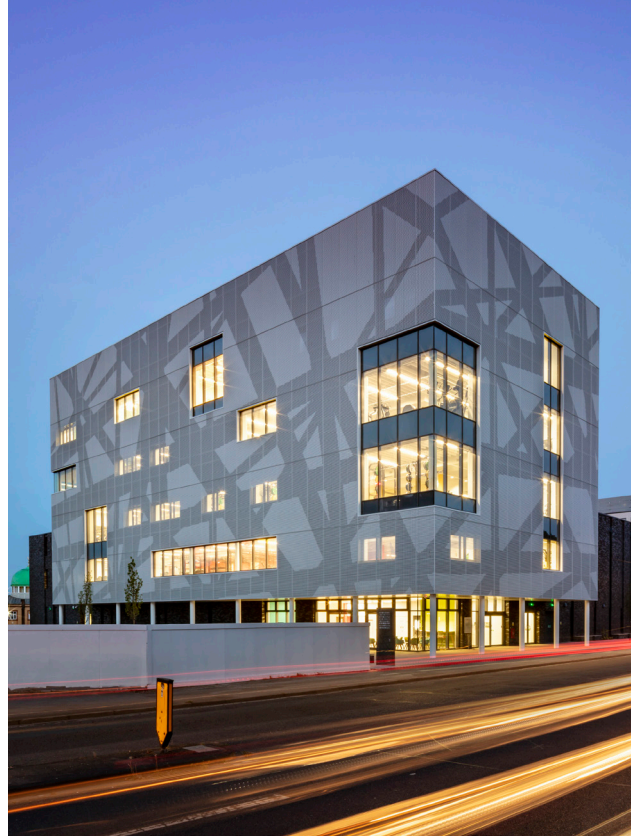

PROJECT DETAIL

Based in a heritage setting opposite a listed park, the specialist sports complex has been designed to achieve the BREEAM 'Excellent' rating and comply with Southampton City Council's core strategy policy, which tackles climate change.

The development was completed in April 2019 with impressive facilities, including two sports halls, three fitness studios, a health and wellbeing gym, spin studios, physiotherapy facilities and a variety of seminar spaces, amongst other teaching facilities. The complex has a contract value of £28 million, just one part of the wider estates development plan to transform the East Park Terrace Campus.

PSP Architectural designed, manufactured and engineered bespoke external panels for the complex, using aluminium to achieve the design brief requirements. Aluminium is a 100% recyclable material that fits in with the ecological project approach. As aluminium is such a flexible and malleable material, we were able to manufacture intricate shapes that made perfect-fit panels for the complex. We welded and powder coated the panels before buffing the welds to conceal the joins and ensure a seamless finish.

We partnered with Coverworld Construction and Morgan Sindall to clad the steel-framed gym tower with a perforated façade that wraps the entire building. We varied the sizes of the circular perforations in the external panels to match the abstraction of the pre-war street layout of the surrounding area. The aluminium façade

conceals some windows and exposes others, revealing activities taking place inside. In darkness, all windows are exposed to create a striking effect on the Southampton night skyline.

We have extensive experience in claddings for educational developments, as well as residential, commercial, retail and other high-profile public sector projects. Further to our expertise in external facades, we also specialise in manufacturing bespoke products for interior fit-outs in commercial projects such as airports and shopping centres.

'We were delighted to collaborate with PSP Architectural on the installation of their entirely unique aluminium façade. The striking external panels are both aesthetically pleasing and future-proofed, protecting against weather elements and corrosion. Students and staff alike will benefit from this outstanding new complex.'

DAVE PARKINSON, COVERWORLD CONSTRUCTION

PSP Architectural

Unit 11 | All Saints Industrial Estate
Sildon | County Durham | DL4 2RD
T: 01388 770490

www.pspuk.com